

LabArt™ Laboratory Steel Casework

Design, manufacturing and performance of all LabArt™ Steel Casework are in compliance with the recommended practice defined by the international standard SEFA-8. All LabArt™ Steel Casework product performance testing is carried out by a SEFA recommended third party SGS company.

- ▶ Load-bearing capacity for single cabinet unit is 907.2 kg (2000 lbs).
- ▶ Load-bearing capacity for single steel adjustable shelf is 90.7kg (200 lbs).
- ▶ Wide 180-degree full swing for cabinet doors.
- ▶ Static drawer load-bearing capacity is 68.0 Kg (150 lbs), tested when opened to 330.2mm (13") and no distortion or deflection after testing.
- ▶ Door panel and hinge load-bearing capacity is tested by applying 90.7 Kg (200 lbs) force directly on the door panel vertically at 304.8mm (12") away from the hinge while opened outwards 90 degrees. No deformation, deflection or deterioration is allowed to occur after testing.

Floor Mounted Steel Base Cabinet Description

Construction

The entire structure is fabricated and shaped with premium grade cold rolled steel sheet, welded and coated with epoxy powder finish. The components and the associated minimum thickness are as follow:

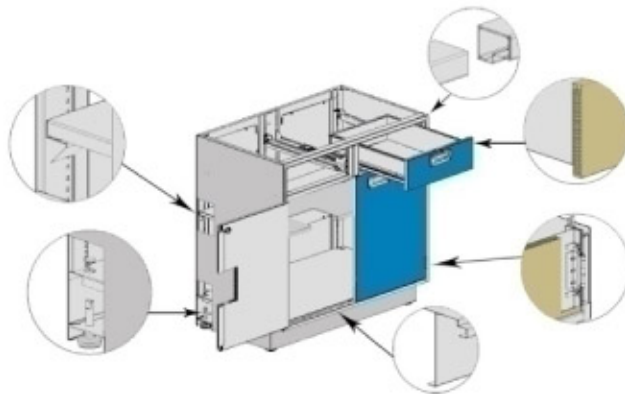

Components	Thickness
Side Panels	1.2mm±5% TH (18 Ga.)
Bottom Panels	1.2mm±5% TH (18 Ga.)
Upper Horizontal Rail Reinforcement	2.0mm±5% TH (14 Ga.)
Lower Horizontal Rails	2.0mm±5% TH (14 Ga.)
Leveling Reinforcement	3.0mm±5% TH (11 Ga.)
Hinge Reinforcement	2.0mm±5% TH (14 Ga.)
Shelves	1.2mm±5% TH (18 Ga.)
Drawer Slide Reinforcement	2.0mm±5% TH (14 Ga.)
Drawers	1.2mm±5% TH (18 Ga.)
Outer Door Panel	1.2mm±5% TH (18 Ga.)
Inner Door Panel	1.0mm±5% TH (20 Ga.)

Base Cabinet Style

All base cabinets are of independent floor mounted units. The double door cabinets are designed to provide unobstructed entry into the cabinet interior with the doors open.

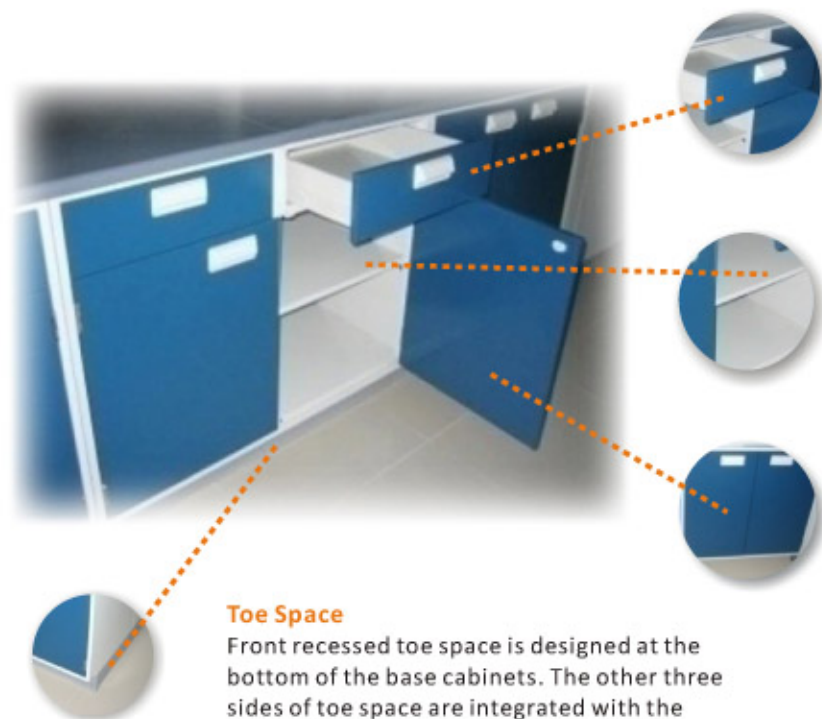

Toe Space

Front recessed toe space is designed at the bottom of the base cabinets. The other three sides of toe space are integrated with the base cabinet side panels without any weldment.

Removable Rear Access Panel

Removable rear access panel provides access for installation and maintenance of utility service lines.

Drawers

The reinforced drawer body structure is free of weldment and screwed onto a separate drawer head. The double-layered drawer head is filled with sound deafening material and is coated with epoxy powder finish on both sides of the layers.

Adjustable Shelves

An adjustable and removable shelf design, with the increment between shelf clips no more than 13mm ($1/2$ "). An intensive full-scale shelf minimizes the gap between the shelf edges and cabinet interior panels to prevent small items from falling through the gap.

Door Panels

Double-layered detachable door panels are filled with sound deafening material. A premium grade cold rolled steel sheet upright interior reinforcement channel provides the strength. Door panels are coated with epoxy powder finish on both sides.



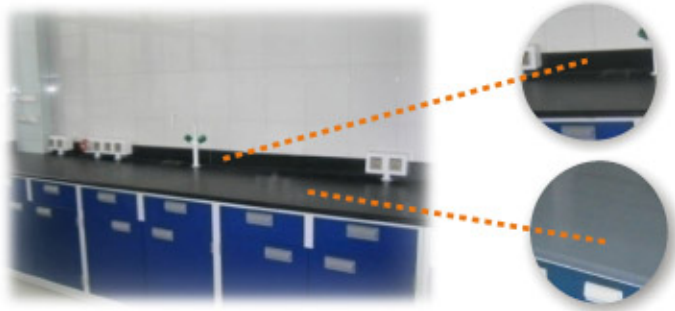

Curb (Backsplash, for side bench)

Curb (backsplash) of the same material as work surface is installed at the rear edge of the side bench tops and against the wall, optional per requirement.

Laboratory Work Surface

Per requirements the epoxy resin, stainless steel, polypropylene, ceramic, solid phenolic work surfaces are available for options.

Hardware

Hinges

A five-knuckle hinge is fabricated from Type 304 stainless steel. In addition to its sturdiness and durability, the hinge also enables the door to open over 180 degrees to provide unobstructed access for large articles.



Drawer Slides

Premium grade cold rolled steel molded slides with epoxy coating are fabricated on both sides of the drawer. Double smooth clamp design provides the stability and durability during the whole travel. The drawer slide, equipped with an auto end lock mechanism, prevents the drawer from shaking and dropping.



Drawer and Door Pulls

The different configurations of stainless steel wire pulls or overlay ABS pulls with label holders are available for options.



Stop Strips

For dust-proofing and aesthetics, a PVC stop strip is fixed to the door panel of the double door cabinet with bolts which are covered by a cap.



Drawer and Door Bumpers

The mortised rubber bumper is clogged on the potential collision points between the drawer head/door panel and the cabinet main body, avoiding glue failure commonly seen on traditional glued strike plates.

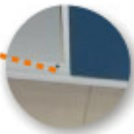

Levelers

The leveler shaft is fabricated from $\phi 14\text{mm} \pm 5\%$ galvanized steel thread rod, and the steel pedestal is wrapped by the non-slip rubber pad.





LabArt™ Laboratory Steel Casework Selections

BCDR-1 ~ 9



BCDR-10 ~ 18



BCDR-19 ~ 24



BCDR-25 ~ 32



BCDR-33 ~ 40



BCDR-41 ~ 48



BCDR-49 ~ 60



BCDR-61 ~ 68



BCDR-69 ~ 80



BCDR-81 ~ 92



BCDR-93 ~ 104



BCDR-105 ~ 116



BCDR-117 ~ 124



BCDR-125 ~ 132



BCDR-133 ~ 144



BCDO-1 ~ 9



BCDO-10 ~ 18



BCDO-19 ~ 30

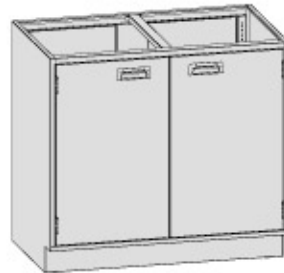

BCDD-1 ~ 9



BCDD-10 ~ 18



BCDD-19 ~ 30

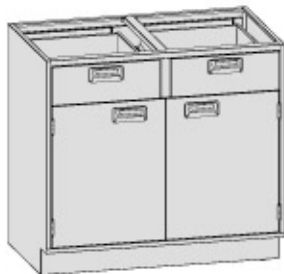

BCDD-31 ~ 42



BCDD-43 ~ 54



BCDD-55 ~ 66



LabArt™ Laboratory Steel Casework Selections

BCDD-67 ~ 78



BCDD-79 ~ 90



BCDD-91 ~ 102



BCDD-103 ~ 110



BCDD-111 ~ 118



BCDD-119 ~ 130



BCDD-131 ~ 142



BCDD-143 ~ 154



BCDD-155 ~ 166



BCDD-167 ~ 174



BCDD-175 ~ 182



MCDR-1 ~ 9



MCDR-10 ~ 18



MCDR-19 ~ 24



MCDO-1 ~ 9



MCDO-10 ~ 18



MCDO-19 ~ 24



MCDD-1 ~ 9



MCDD-10 ~ 18



MCDD-19 ~ 24



CC-1 ~ 3

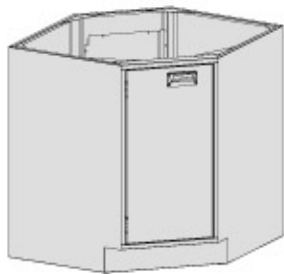

CC-4 ~ 6



CC-7 ~ 9



CC-10 ~ 12



LabArt™ Laboratory Steel Casework Selections

SC-1 ~ 12

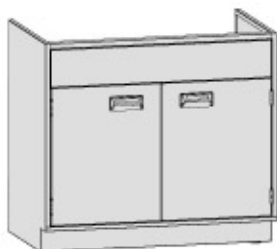

SC-13 ~ 21

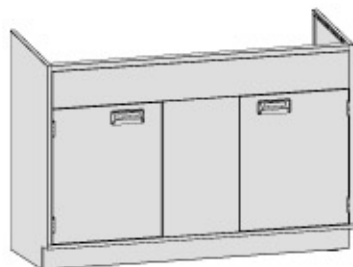

BT-1 ~ 3



BT-4 ~ 5



WHC-1 ~ 4

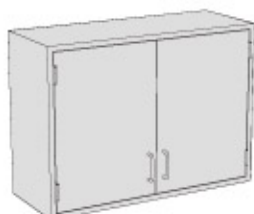

WHCG-1 ~ 4

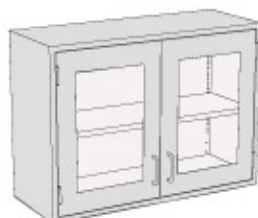

WHCS-1 ~ 4



WHCGS-1 ~ 4

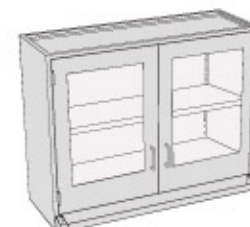

VRSC-1 ~ 5



VRSCG-1 ~ 5



RSC-1 ~ 5



RSCG-1 ~ 5



VSCG-1 ~ 2



VSCG-3



VRSCP-T-1 ~ 5



VRSCP-FH-1 ~ 10

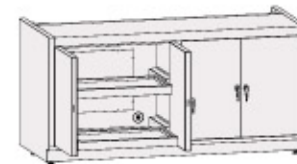

BCC-1 ~ 6

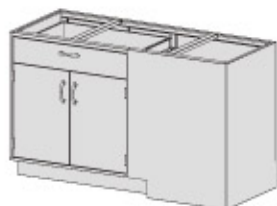

BCC-7 ~ 12

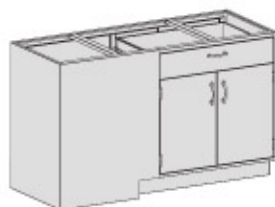

VPC-1 ~ 2

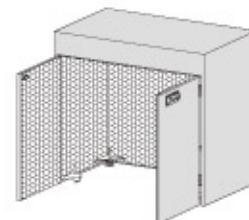

VPCM-1 ~ 2



KS-1 ~ 15

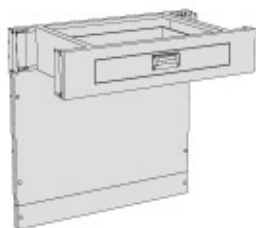

KS-16 ~ 24

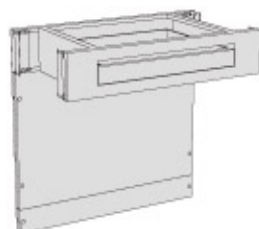

KS-25 ~ 33

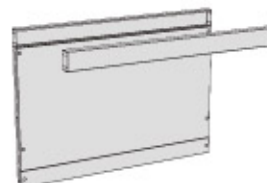

LabArt™ Laboratory Steel Casework Selections

ES-1 ~ 2

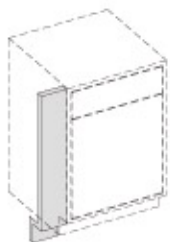

COFP-1 ~ 2

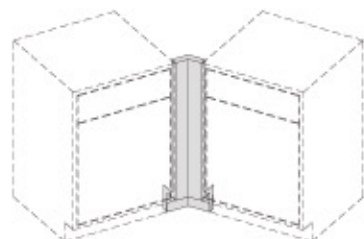

FFP-1 ~ 2

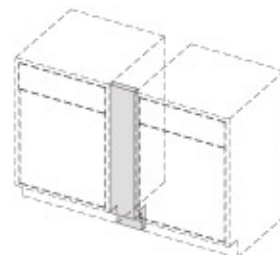

EF-1 ~ 2

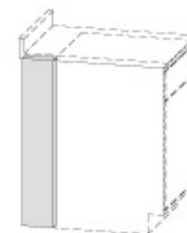

CEFP-1 ~ 2

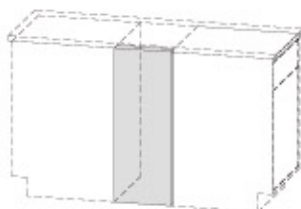

FT-1 ~ 10



FT-11 ~ 20



FT-21 ~ 40

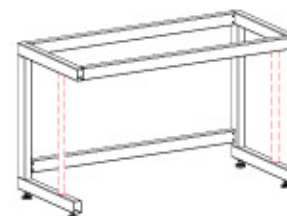

MT-1 ~ 10



MT-11 ~ 20



MT-21 ~ 40

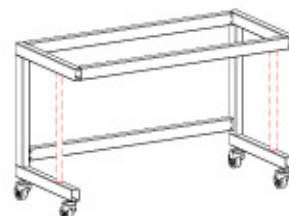

CTS-1



IRSR-1 ~ 9



WRSR-1 ~ 9



IRS-1 ~ 9



WRS-1 ~ 9



IUPS-1



IUPC-1



WUPS-1



WUPC-1



SS-1 ~ 10

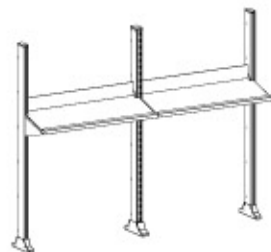

USC-1 ~ 2



USC-3 ~ 4



USC-5 ~ 6



Casework Door / Drawer Pull

SSP-1



Streamline style stainless steel

SSP-2 ~ 3



C style stainless steel

AAP-1



Streamline style Al-Mg alloy

AAP-2



C style Al-Mg alloy

OAP-1



Overlay style ABS plastic (Black)

OAP-2

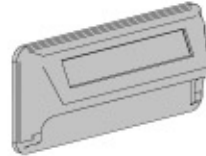

Overlay style ABS plastic (Gray)

OAP-3



Overlay style ABS plastic (Burgundy)

OAP-4

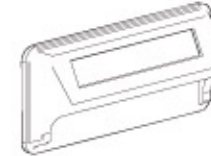

Overlay style ABS plastic (Ivory)

FAP-1



Flush style ABS plastic (Black)

FAP-2



Flush style ABS plastic (Gray)

FAP-3



Flush style ABS plastic (Ivory)

Receptacle / Data / Phone Raceway

RW-1

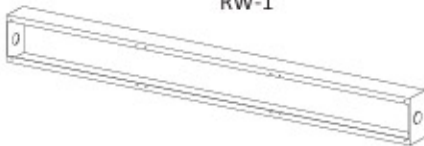

RWR-1



RWD-1

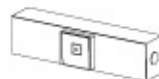

RWB-1

